

residential architect

hanley wood

MAY 2008

08

residential architect
design awards

matthew trzebiatowski's
high-wire act wins
project of the year

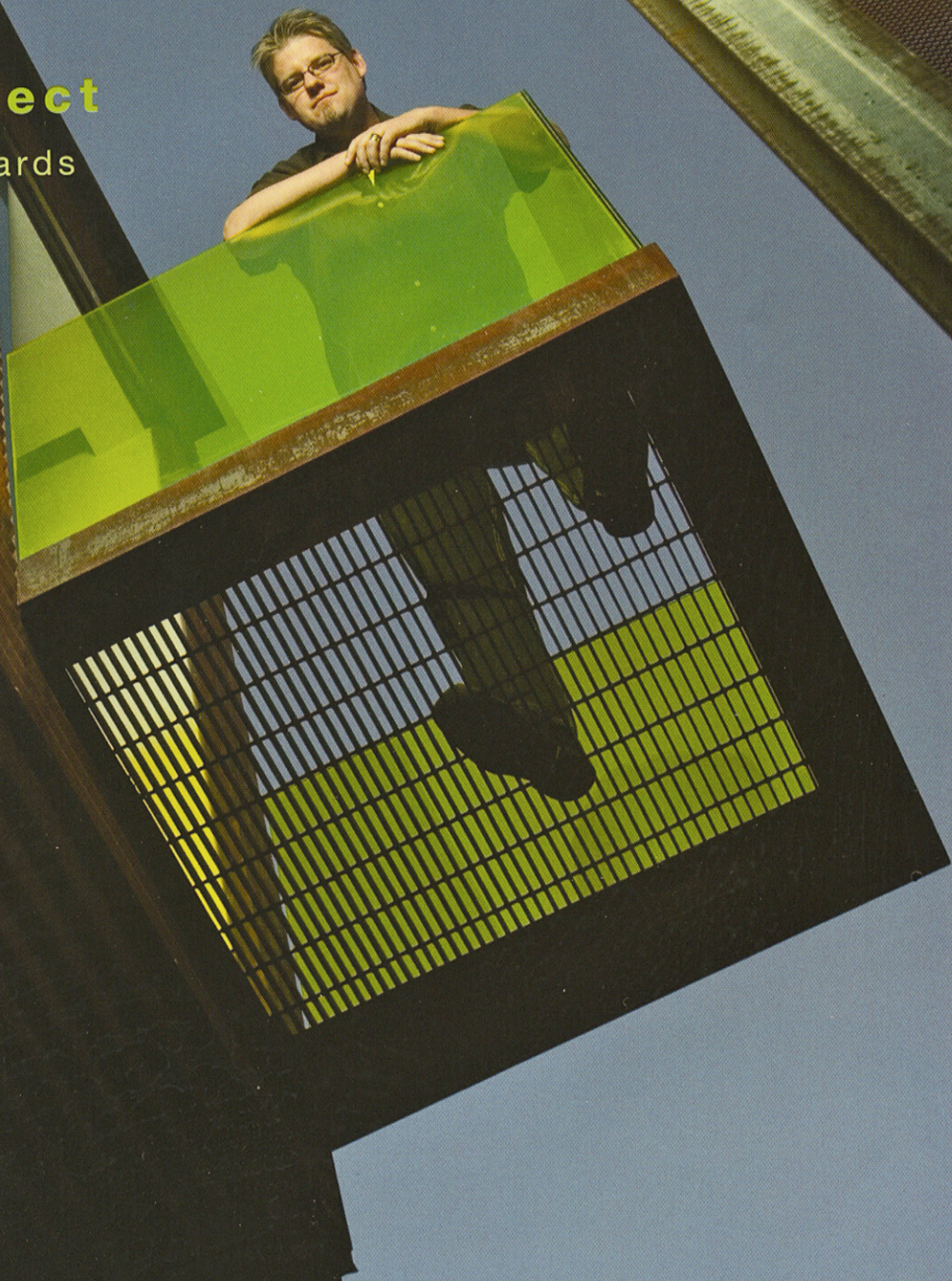

www.residentialarchitect.com

contents



page 28

Randy Brown's Grand experiment is his own house: Laboratory.
Photo: Assassi@2008. Cover photo: Danny Turner.

from the editor.. page 11

practice.. page 13

What's in BIM for you?

cover story: residential architect design awards 2008.. page 28

by Meghan Drueding, Shelley D. Hutchins, Cheryl Weber, and Nigel F. Maynard

project of the year.. page 29

blank studio for Xeros Residence

custom / 3,500 square feet or less.. page 32

Grand: Stelle Architects; SALMELA ARCHITECT

Merit: Aleks Instanbullu Architects; Rockhill and Associates

custom / more than 3,500 square feet.. page 38

Grand: Elliott + Associates Architects; Randy Brown Architects; Voorsanger Architects

Merit: Studio Dwell Architects; Turnbull Griffin Haesloop

renovation.. page 50

Grand: Brian Pittman, AIA, and McCarty Holsaple McCarty; Fougeron Architecture

Merit: Höweler + Yoon Architecture; Miró Rivera Architects

adaptive reuse.. page 60

Grand: Cho Benn Holback + Associates

Merit: Bonstra | Haresign Architects

multifamily.. page 64

Grand: Circle West Architects; Office dA and Burt Hill

Merit: The Miller|Hull Partnership and Studio Dwell Architects; Edward M. Baum FAIA, Architect

single-family production / attached.. page 72

Grand: Rogers Marvel Architects

single-family production / detached.. page 74

Grand: Randy Brown Architects

Merit: Johnsen Schmalig Architects

campus housing.. page 78

Grand: Machado and Silvetti Associates + Gould Evans, LLC

affordable.. page 80

Grand: Kanner Architects

Merit: Faleide Architects

architectural interiors.. page 85

Grand: Minarc

Merit: Desai/Chia Architecture; John Hubert Architects; Rockhill and Associates

bath.. page 89

Grand: chadbourne + doss architects

outbuilding.. page 91

Merit: Shipley Architects

architectural design detail.. page 91

Merit: Hanawalt Architecture & Land Planning

on the boards.. page 93

Merit: Visible Research Office; Office em

judges' award.. page 104

John Malick & Associates

multifamily

merit

prototype infill housing; throckmorton site, dallas

edward m. baum faia, architect

dallas

Edward M. Baum, FAIA, says the design for this prototype duplex housing is a creative solution to the 50-foot-by-150-foot infill sites common in Dallas, and he's optimistic it can be adapted to other cities. Instead of a conventional single-family house or a low-rise multifamily building, "these smaller homes fit more gracefully on a site," he says.

The linear-shaped, two-bedroom units are aimed at smaller households or live/work arrangements, without sacrificing the precious amenities of a single-family house. Owners use garage doors to enter their units, passing through inviting crushed-rock courtyards. "This really does reconsider how you enter the house," said one judge. "And it's handled in a beautiful and pragmatic way. When you open the door, it's a fantastic experience."

Inside, the main public space consists of a combination kitchen/living/dining room; a narrow gallery leads to the private rooms and additional outdoor spaces. Baum designed the homes for affordable construction using typical lumberyard materials, such as painted 2x12 rafters, waxed concrete floors, and drywall. Even the roof—tapered rigid foam insulation installed on the outside—is a typical commercial spec. "The only custom products are the windows," Baum says. Our judges admired the project's modesty and praised its "elegant, simple moves."—*n.f.m.*

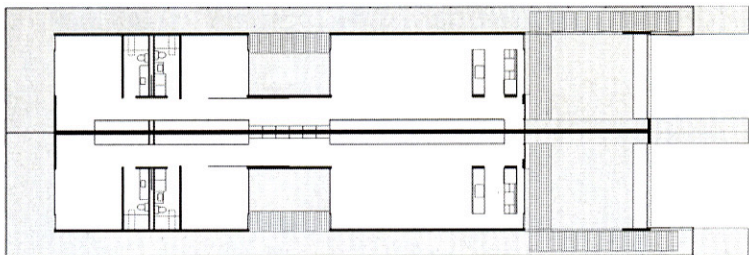

principal in charge / project architect: Edward M. Baum, FAIA, Edward M. Baum FAIA, Architect; **developer:** Diane Cheatham, Urban Edge Developers, Dallas; **general contractor:** Diane Cheatham, CCM Group, Dallas; **project size:** 1,660 square feet per unit; **site size:** 0.34 acre; **construction cost:** \$101 per square foot; **sales price:** \$275,000 to \$290,000 per unit; **units in project:** 4; **photography:** Hester + Hardaway. Please visit www.residentialarchitect.com for product information.

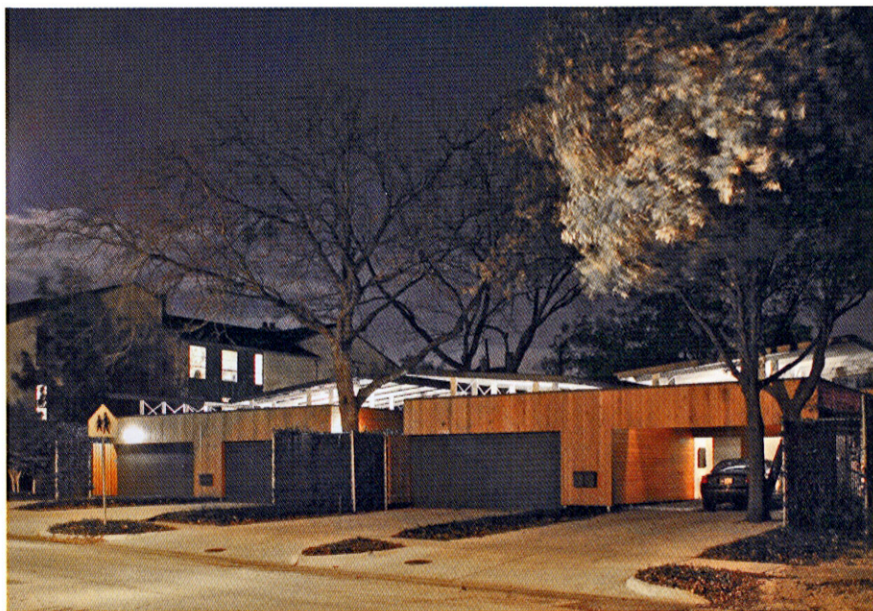

Proving that his infill housing prototype can be applied anywhere, Edward M. Baum designed these houses before securing the site. The homes offer three courtyards, cypress siding, bamboo countertops, and waxed concrete floors.